

658 LIVE OAK DRIVE, MCLEAN, VA

©2022 HRL PARTNERS – HRYNIEWICKI, RACKLIFFE, LEARY

WWW.INTERIORFOOTPRINTS.COM

ALL ILLUSTRATIONS, DIMENSIONS AND SQUARE FOOTAGE ESTIMATES ARE APPROXIMATE AND MAY VARY FROM ACTUAL STRUCTURE. DIMENSIONS HAVE BEEN ROUNDED.

ESTIMATED SQUARE FOOTAGE: 16,100 TOTAL (14,150 LIVABLE)

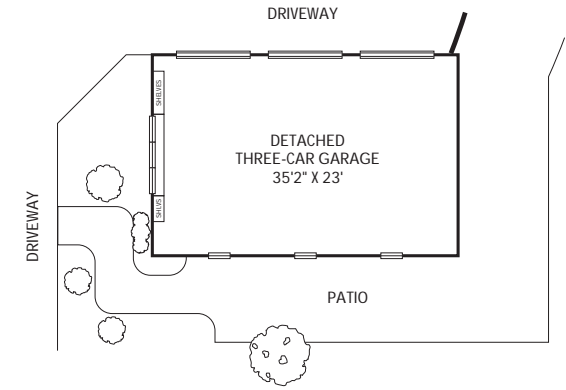
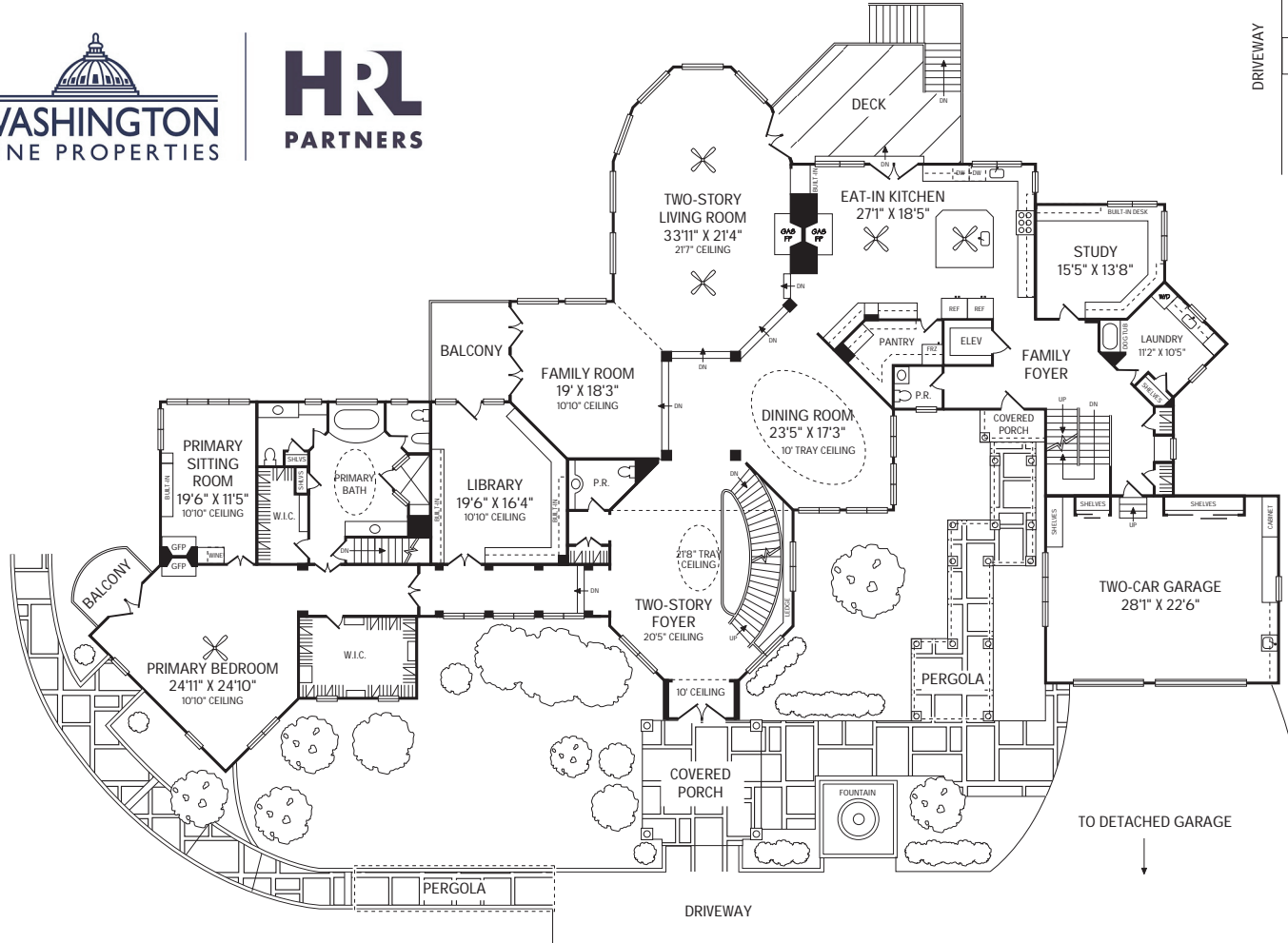

MAIN LEVEL
9'10" CEILING

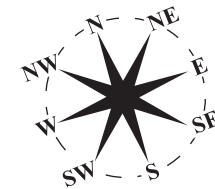

TO DETACHED GARAGE
↓

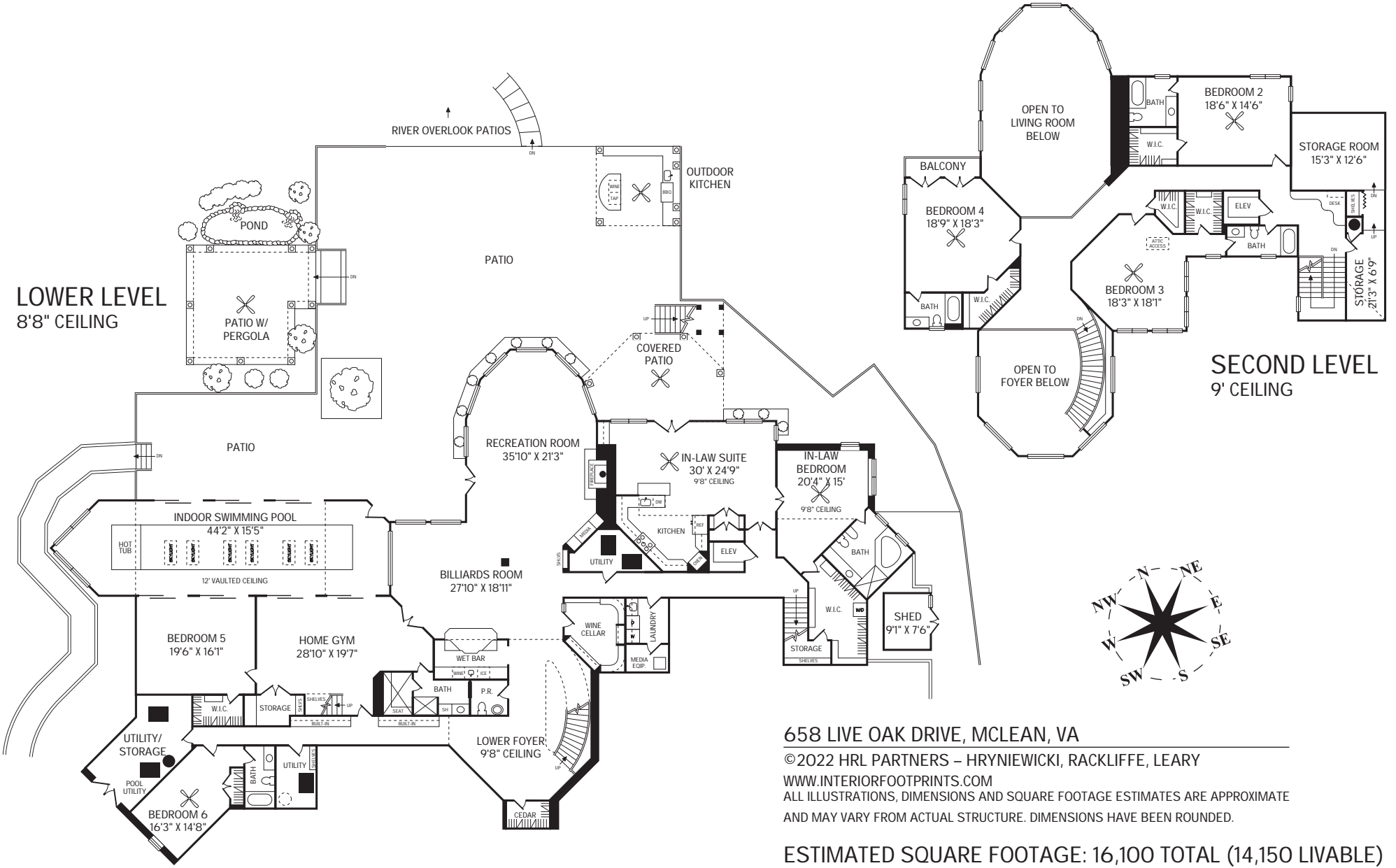

LOWER LEVEL
8'8" CEILING

SECOND LEVEL
9' CEILING

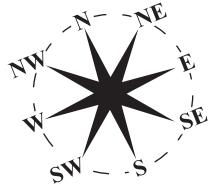

658 LIVE OAK DRIVE, MCLEAN, VA

© 2022 HRL PARTNERS – HRYNIEWICKI, RACKLIFFE, LEARY

WWW.INTERIORFOOTPRINTS.COM

ALL ILLUSTRATIONS, DIMENSIONS AND SQUARE FOOTAGE ESTIMATES ARE APPROXIMATE AND MAY VARY FROM ACTUAL STRUCTURE. DIMENSIONS HAVE BEEN ROUNDED.

ESTIMATED SQUARE FOOTAGE: 16,100 TOTAL (14,150 LIVABLE)